

AC3 / 5 / 10

WIREWOUND MULTI-TURN POTENTIOMETER

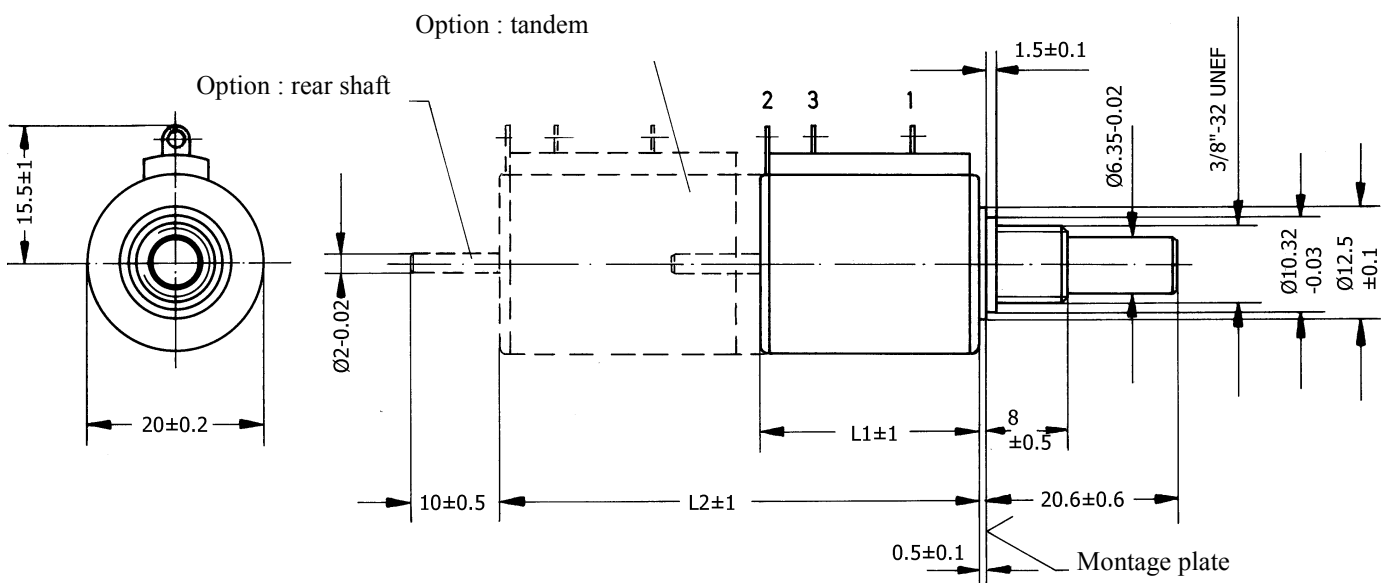

- 3, 5 or 10 turns
- 20 Ω to 200 k Ω
- Linearity ± 0.2 %
- Tandem version



	AC3	AC5	AC10
L1 (mm)	18	18	25.5
L2 (mm)	38	38	53

Spécifications électriques	AC10	AC5	AC3
Resistance value (Ω)	20 50 100 200 500 1k 2k 5k 10k 20k 50k 100k 200k	10 20 50 100 200 500 1k 2k 5k 10k 20k 50k 100k	10 20 50 100 200 500 1k 2k 5k 10k 20k 50k
Tolerance (%)	± 3	± 3	± 3
Linearity (%)	± 0.2	± 0.2	± 0.2
Power at 20°C (0 to +105°C) (W)	3	2.5	2
Electrical stroke $\pm 5^\circ$ ($^\circ$)	3600	1800	1080
Residual (%) <2k >2k		± 0.2 ± 0.1	
Insulation		1000 M Ω	
Noise E.N.R. (Ω)		< 100	
Spécifications mécaniques			
Mechanical stroke ($^\circ$) +15 -0	3600	1800	1080
Operating friction (Ncm)	0.4	0.4	0.4
Stopper strength (Ncm)	80	80	80
Axial backlash (mm)	0.2	0.2	0.2
Radial backlash (mm)	0.1	0.1	0.1
Life time (operations)	2x10 ⁶	2x10 ⁶	2x10 ⁶
Guiding	sleeves	sleeves	sleeves
Weight (g)	25	20	20
Environmental spec.			
Operating temperature ($^\circ$ C)		-55 à +105	
Dielectric strength		1000 VDC	
General conditions		MIL-R-12934	
Material			
Housing		Polyamide	
Shaft		Amagnetic stainless steel	
Pins		Gold coloured brass	
Accessories		Nuts	

Value Ω	N° of winding			Resolution (%)			Max. voltage (V)			Max. current (mA)			ppm/K
	AC10	AC5	AC3	AC10	AC5	AC3	AC10	AC5	AC3	AC10	AC5	AC3	
10	-	980	720	-	0.1020	0.1390	-	5	4	-	500	447	700
20	1850	1220	970	0.0541	0.0820	0.1030	8	7	6	370	353	316	700
50	2550	980	750	0.0392	0.1020	0.1330	12	11	10	250	223	200	700
100	1900	1050	970	0.0526	0.0950	0.1030	17	16	14	176	158	141	80
200	2250	1250	980	0.0445	0.0800	0.1020	24	22	20	125	112	100	80
500	3300	1550	1180	0.0304	0.0645	0.0850	39	35	32	73	71	63	80
1k	3600	1900	1500	0.0288	0.0526	0.0666	55	50	44	54	50	44	20
2k	4050	2400	1990	0.0247	0.0417	0.0503	77	70	63	39	35	32	20
5k	5100	3250	2000	0.0196	0.0308	0.0500	122	112	100	25	22	20	20
10k	6200	4000	3050	0.0162	0.0250	0.0328	172	158	141	17	16	14	20
20k	7750	5200	3500	0.0129	0.0193	0.0286	245	223	200	12	11	10	20
50k	10000	7100	4500	0.0100	0.0141	0.0222	385	353	316	8	7	6	20
100k	14000	8700	-	0.0071	0.0150	-	300*	500	-	6	5	-	20
200k	17500	-	-	0.0057	-	-	500*	-	-	6	-	-	20

Do not overall 35 mA wiper current
* no more than 500V

In our range, we also offer counting dials.

Kindly contact us for any special version.

Technical datas can be modified without notice

Main possible options :
Special Tolerance et linearity.
Special shafts (diam, length)
Rear shafts
Tandem version

Upon special request :
Special electrical strokes
Neutral zones